

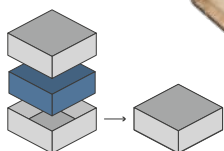

ORGANIZER - COMPATIBLE WITH LORENZO IL MAGNIFICO BIG BOX



Designed to fit into the game box; flush closure is guaranteed. Progettato per inserirsi all'interno della scatola del gioco; garantisce chiusura a filo*



Designed for both sleeved and unsleeved cards. Adatto sia per carte imbustate che non imbustate*

72

Pieces to assemble
Pezzi da assemblare

30.1 x 21.1 x 4.3 cm

Size of assembled organiser
Dimensioni organizer assemblato

ORGANIZER CAPACITY

1x card holder with slots for each type and period; 4x resource holder with slots for coins, stones, wood, workers and special tokens; 1x player set tray, with 5 removable shutters; 1x holder for leader cards and family tiles; 1x setup tray with slots for excommunication tiles, 2-3 player tokens, dice, exp tokens. 1x portacarte con slot per ogni tipologia e periodo; 4x portarisorse con slot dedicati per monete, pietre, legno, lavoratori e gettoni speciali; 1x tray per set giocatori, con 5 saracinesche rimovibili; 1x contenitore per carte leader e tile famiglia; 1x tray setup con slot per token scomunica, token 2-3 giocatori, dadi, token espansioni.



* Any doubt?
Check out our FAQ page or download the digital version of the instructions on our website!

All trademarks and copyrights are the property of their respective owners.
This product is not a toy. Contains small parts that can be swallowed or inhaled. 14+





ORGANIZER - COMPATIBLE WITH LORENZO IL MAGNIFICO BIG BOX

TUTORIAL - THE DICETROYERS DICE!

Among the pieces to assemble, you'll find a dice. This is not part of the organizer, but it can be a good starting point to practice!

Tra i materiali da assemblare troverai un dado. Questo componente non fa parte dell'organizer, né del gioco, ma è un ottimo punto di partenza per fare un po' di pratica.

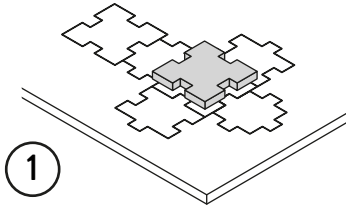

1

Gently take off
all the pieces.
Stacca delicatamente
dal foglio tutti i pezzi.

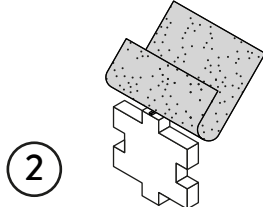

2

If necessary, use sand paper to
smoothen the borders.
Se necessario rifila con carta
vetrata per legno eventuali
imperfezioni dei pezzi.

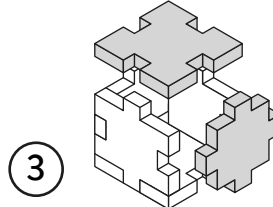

3

Get familiar with
all the pieces
and check the correct assembly
sequence.
Prendi familiarità con tutti
i pezzi, per assicurarti
che la sequenza di assemblaggio sia
corretta.

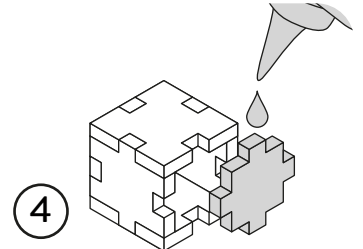

4

Once verified the correct assembly
sequence, just add a small quantity
of PVA glue on every joint.
Dopo aver verificato
la sequenza di assemblaggio
aggiungi una piccola quantità di
colla vinilica su tutti
gli incastri per garantirne
la durata nel tempo.

INSTRUCTIONS

A



DT-112A

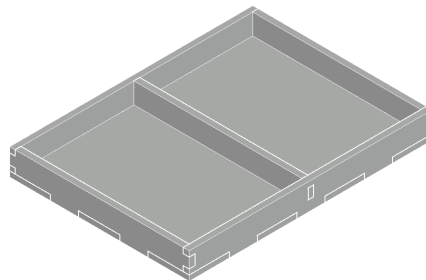
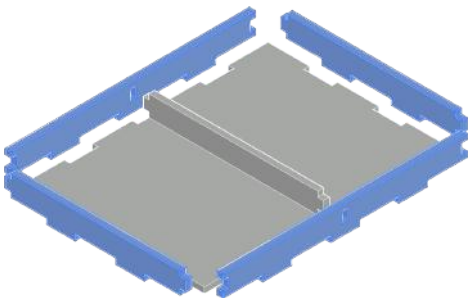
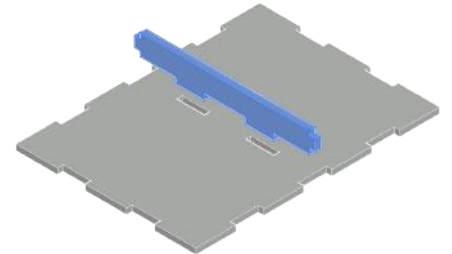
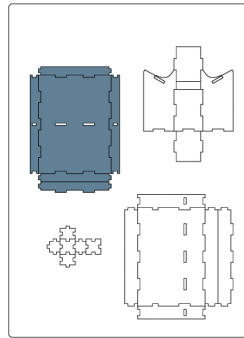

B



DT-112A

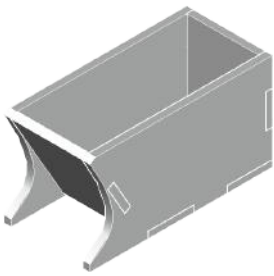
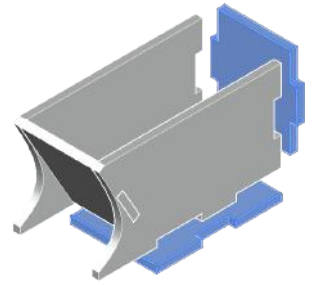
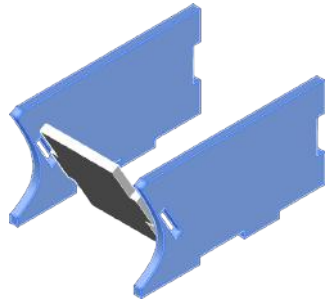
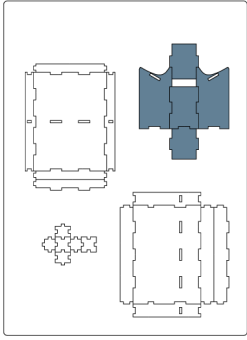

C



DT-112A

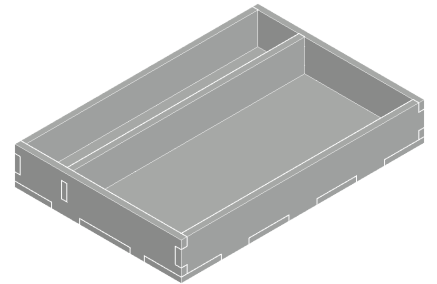
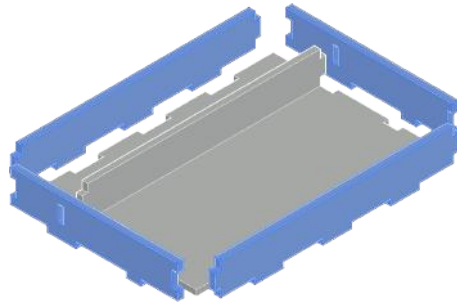
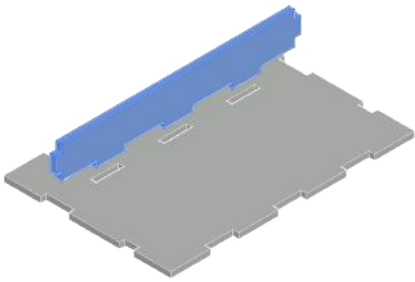
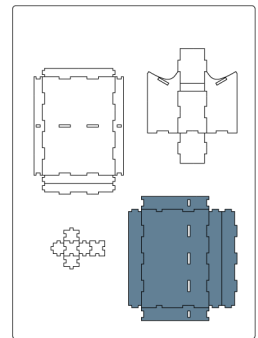

D



DT-112B

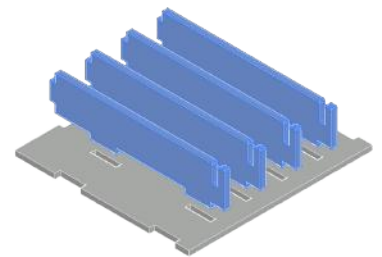
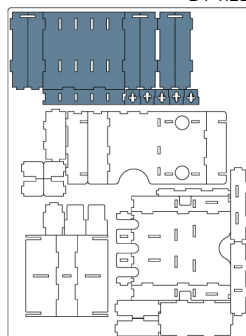

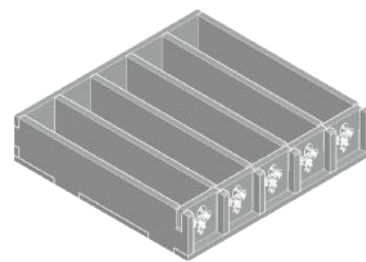
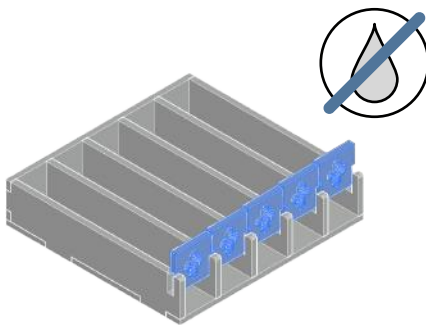
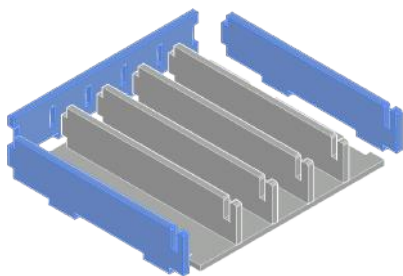

NOTE: Don't use glue on these joints; these pieces can be removed during the game. Non usare colla su questi incastri, pezzi rimovibili durante il gioco.

E

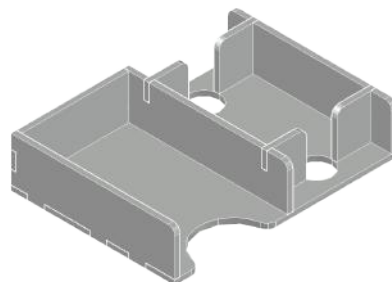
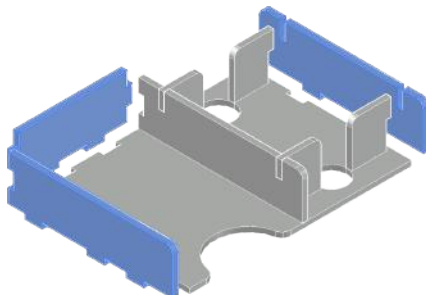
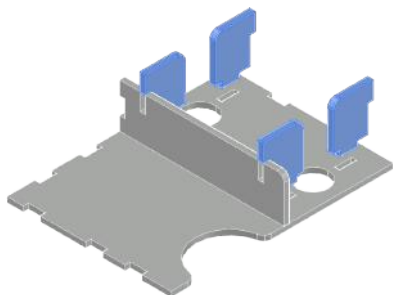
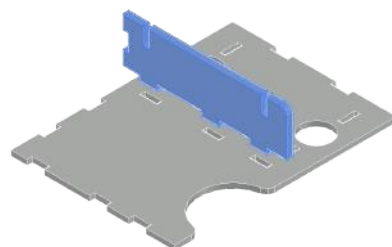
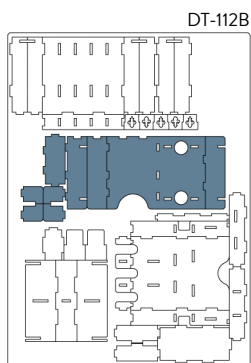

F

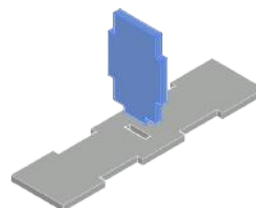
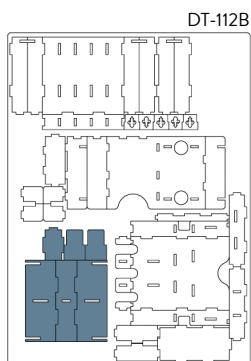

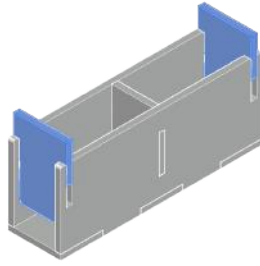
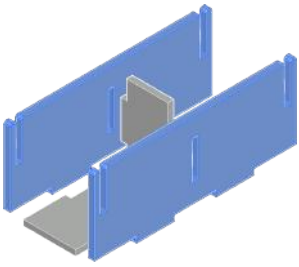

NOTE: Don't use glue on these joints; these pieces can be removed during the game. Non usare colla su questi incastri, pezzi rimovibili durante il gioco.

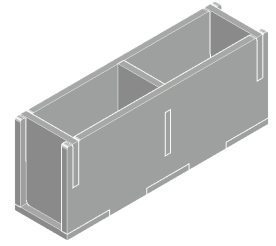

G



DT-112B

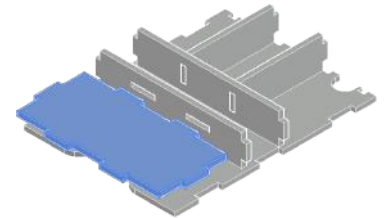
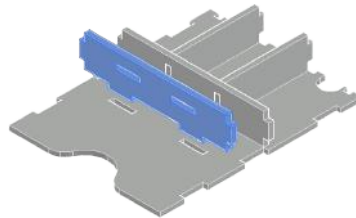
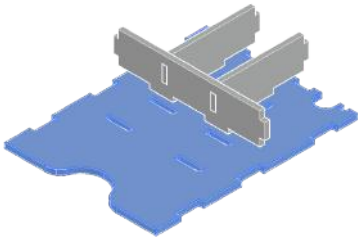
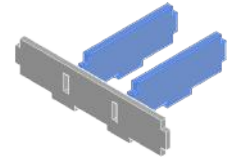
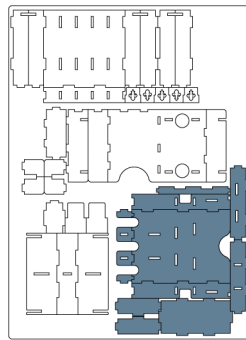

H

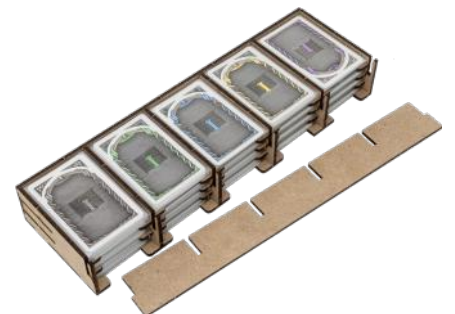
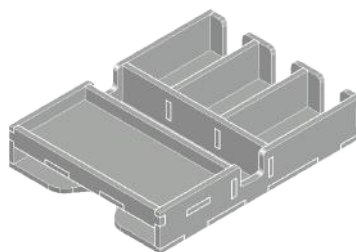
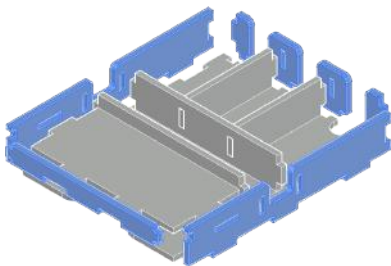

DT-112C

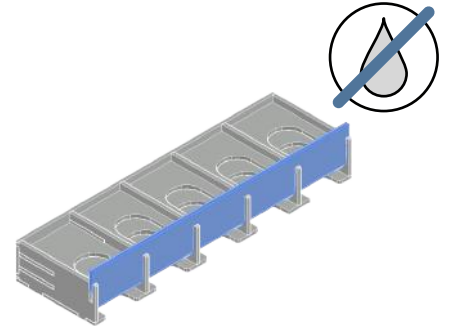
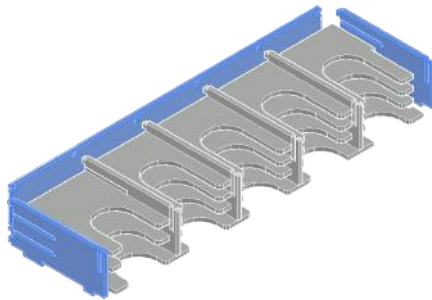
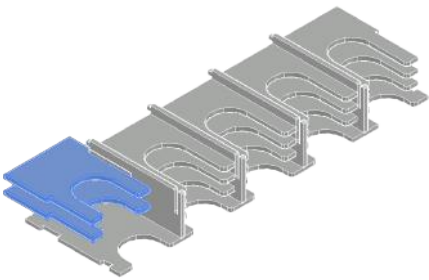
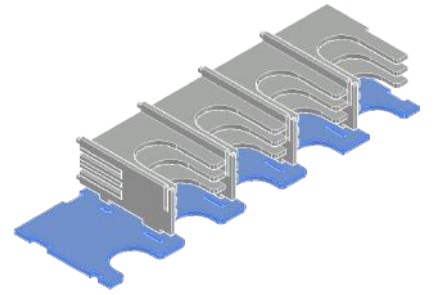
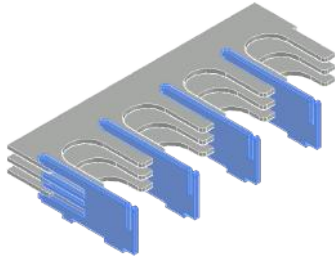
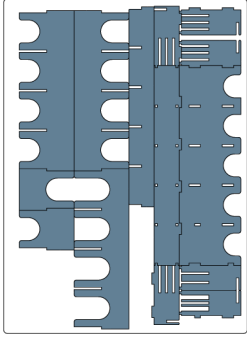

NOTE: Don't use glue on this joint; this piece can be removed during the game. Non usare colla su questo incastro, pezzo rimovibile durante il gioco.

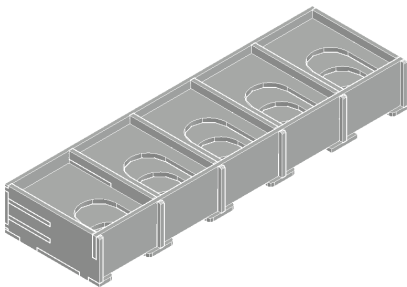

REBOXING SEQUENCE!



Every piece will stay in its slot. Follow the reboxing sequence to properly store your organizer. We recommend using a h-band to avoid accidental box opening. Don't shake. Ogni componente rimarrà al suo posto. Segui la sequenza di reinserimento per riporre nella maniera corretta il tuo organizer. Consigliamo l'utilizzo di una h-band per evitare aperture accidentali. Non scuotere.

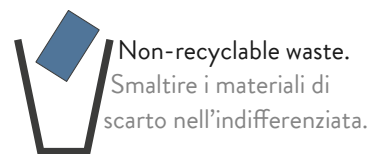

All trademarks and copyrights are the property of their respective owners.
This product is not a toy. Contains small parts that can be swallowed or inhaled. 14+